

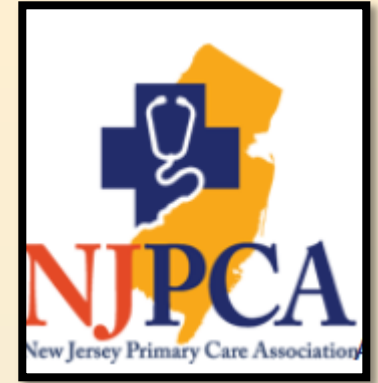

Tri-State Canine Response Team

The Role of Crisis Response K-9's to a Mass Casualty Event



*Planning
Response
Recovery*

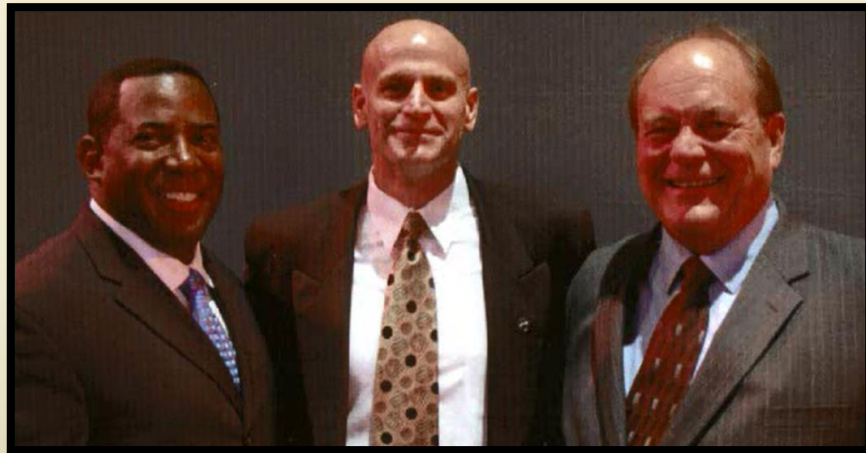



Tri-State Canine Response Team

- **501(c)(3) Non-Profit Organization**
- **Founded in 2015**
- **Primary Service Area includes NJ, PA, and Delaware**
- **National Response Capability**





Membership and Affiliations

- New Jersey Volunteer Organizations Active in Disaster

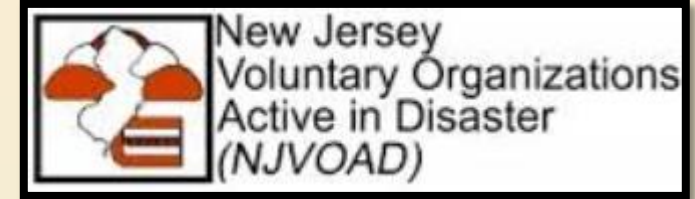

- United Way (Donor # 52466)

- Follow Guidelines of National Animal Assisted Crisis Response (National AACR) Standards



- Certified Disaster Response Crisis Counselors

- Certifying Organization Presidential Award for Volunteer Services





Finance / Administration Section:

Administration Section:

- Recruit, Train and Certify Teams
- Conduct Background Checks with Finger Printing
- Provide Educational Programs
- Supply Uniforms for Canines & Handlers





Finance / Administration Section:

Finance Section:

- Provide Insurance Coverage
- Fund Deployments
- Individual Donors
- Corporate Sponsors
- Fund Raising Activities
 - Tri-State K-9: 5K Run & Fun
 - Bingo
 - Yappy Hour

SAVE THE DATE



20 **18**

**Saturday,
September 22, 2018**

What: Tri-State K-9: 5K Run & Fun

When: **Saturday,
September 22, 2018**

Where: Cooper River Park
Pennsauken, NJ

Time: 9am-12pm

Other: Watch for details about the coveted Tri- State Cup!

The 5K will be followed by a party in the park including food, awards & gifts, entertainment, vendors, and more!



Volunteer Operational Teams

- Handlers and Canines are prescreened to assess suitability for intended work
- Handlers are required to:
 - **Background check** to include fingerprint review
 - **Training** in areas specific to Tri-State response requirements
 - **Certification commensurate with level of work being performed**
- Abide by organizational standards as detailed in the Tri-State Canine Response Team Handbook



Thursday,
November 17, 2016





Operational Services Provided

- Animal Assisted **Activities**
 - Use of animals to provide emotional support in a variety of settings
- Animal Assisted **Therapy**
 - Goal based intervention to improve social, emotional, or cognitive functioning
- Animal Assisted **Crisis Response**
 - Specialized intervention to assist & support during crisis or disaster





Caring K9's

REQUIREMENTS

- Registration with national therapy dog organization
- Background check and finger printing
- Training
 - Human & Canine CPR/First Aid
 - Canine Body Language
 - Introduction to Canine Handling
 - HIPAA Training





Veterans



Youth Services

First Responders





Operational Crisis Response Team (CRT)

REQUIREMENTS

- Meet Caring K-9 Prerequisites
- 1 year of AAT experience or equivalent
- AKC Canine Good Citizen Certificate
- Additional training/education:
 - FEMA Incident Command
 - Psychological First Aid
 - Human and Canine First Aid & CPR
 - Advanced Temperament/Resiliency Testing and Role Playing





GUNTHER: CD, THDD, RE, ATTS, CGCU



Tri-State K-9 Crisis Response Team

John Hunt

and

Gunther

Have completed the specialized training and have been recorded as a

2017

Certified Working Service Dog



Janice Campbell
Janice Campbell
Co-Founder

Andrea Hering
Andrea Hering
Co-Founder

A certified working service dog, has the right to accompany the handler where ever the handler has a lawful right to be. It is appropriate and essential that this team be permitted unrestricted access to the same accommodations and allowances granted to other kinds of working service dogs.

Tri-State K-9 Crisis Response Team

Certified Crisis Response Dogs Providing a Bridge to the Healing Process

Have completed the specialized training and have been recorded as a

2017

Certified Working Service Dog



***Crisis: Providing aid during or after an intense event.
Shooting, fire, untimely death, suicide, accident, illness and
other such challenging experiences.***

A certified working service dog, has the right to accompany the handler where ever the handler has a lawful right to be. It is appropriate and essential that this team be permitted unrestricted access to the same accommodations and allowances granted to other kinds of working service dogs.



Operations Section

- **2017 Operations Report**
 - 36 Teams
 - 23,138 Support Encounters
- **Significant Operational Deployment include:**
 - **PULSE - Orlando, FL (June 2016)**
 - **Route 91 Festival – Las Vegas, Nev (October 2017)**
 - **First Baptist Church – Sutherland Springs, Texas (November 2017)**
 - **Marjory Stoneman Douglas – Parkland, Florida (February 2018)**
- **Community Operations**
 - Hospitals
 - Schools and Universities
 - Library Reading Program
 - Homeless Shelter
 - Psychiatric Treatment Programs
 - Church
 - Veteran's Home
 - Group Homes
 - Community Outreach





Planning Section / Logistics Section

Deployment:

- Define Mission of Deployment
- ICS Adherence
- No ADHOC
- Communication w/ Incident Command Post
- Operational Planning
- Established Point of Contacts
- Memorials / Vigils
- Viewings / Funerals
- Services
- First Responders
- Local Interactions

Event:

- Deployment Considerations
- K9 Teams
- Certification Status
- Travel
- Billeting
- Meals
- Other expenses
- Communications
- Networking Capability



PULSE

June 12, 2016



**50 Deceased
53 Injured**







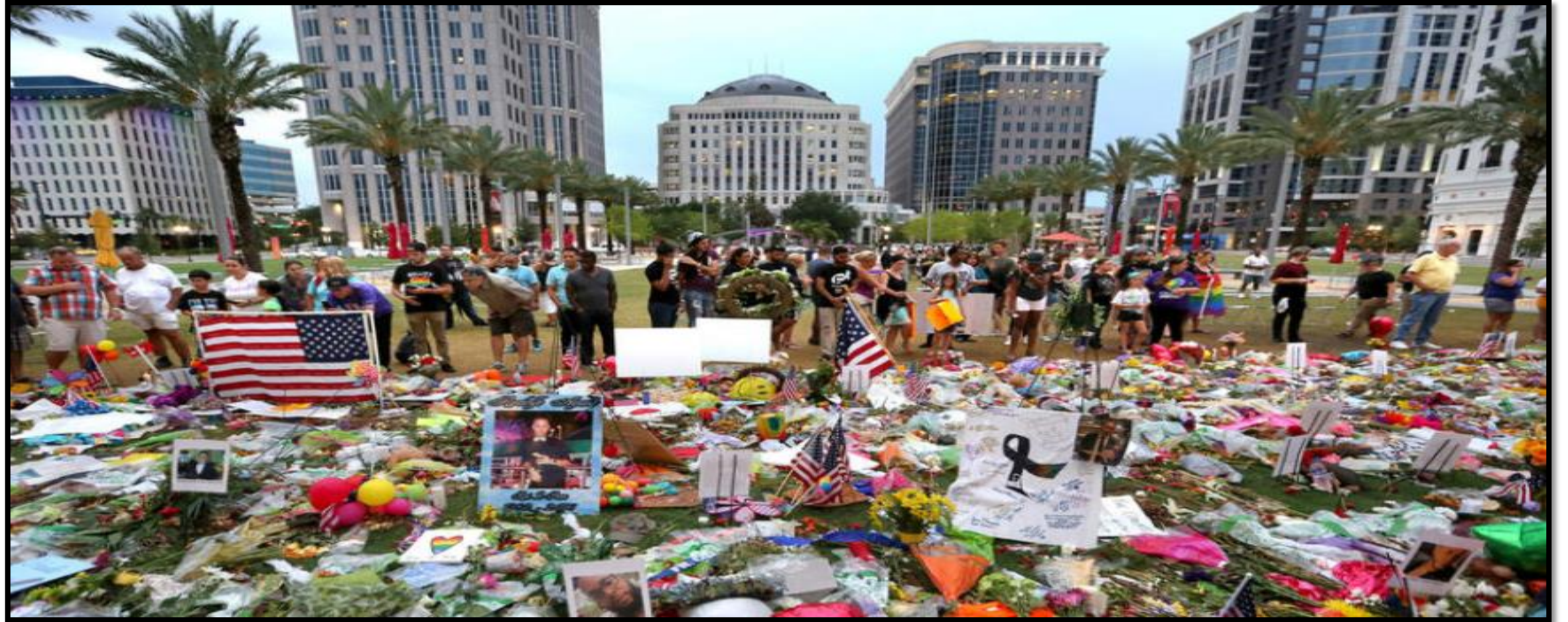





Pulse Night Club

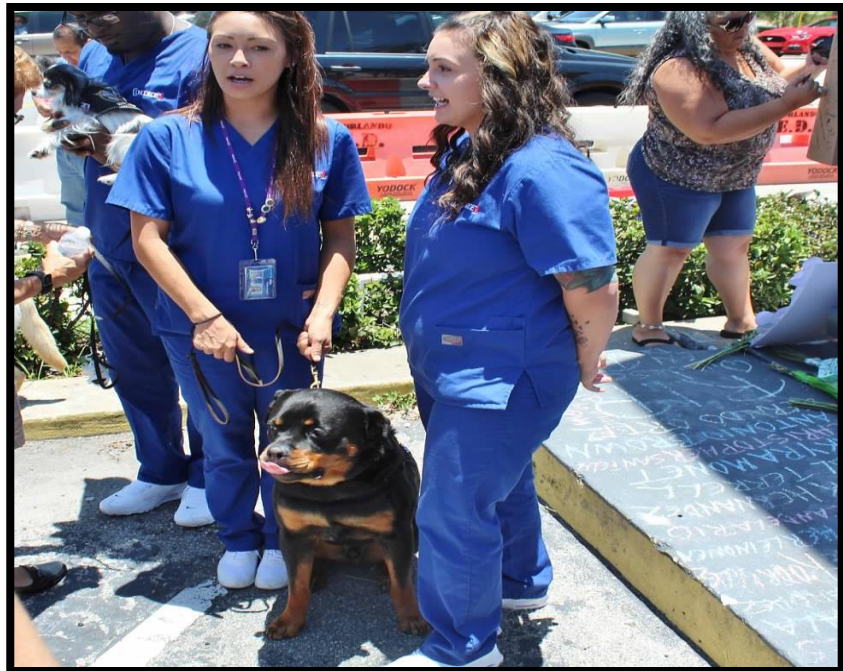



Florida Dept. of Law Enforcement





The 49 Cross Memorial



ORLANDO
FIRE
DEPT.



FIRE
STATION
5





Route 91



Oct. 1, 2017
Attendance:
22K

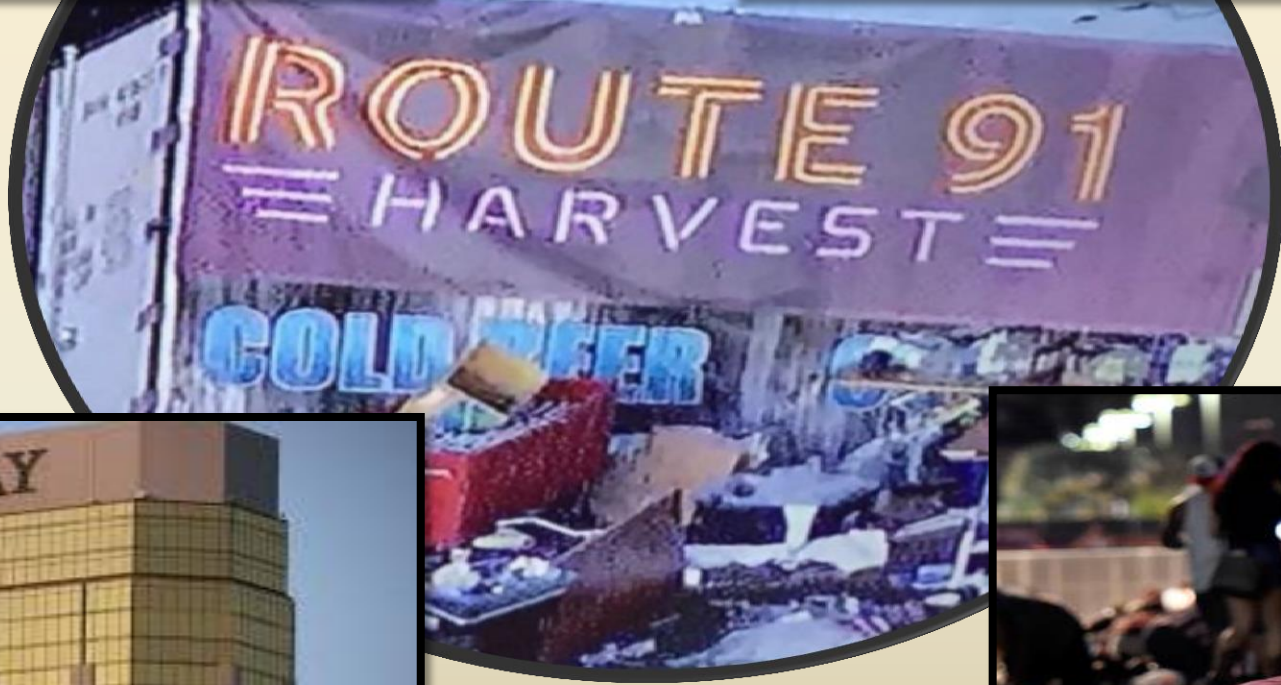

58 killed
Over 851 Injured
422 by GF





58 Cross Memorial

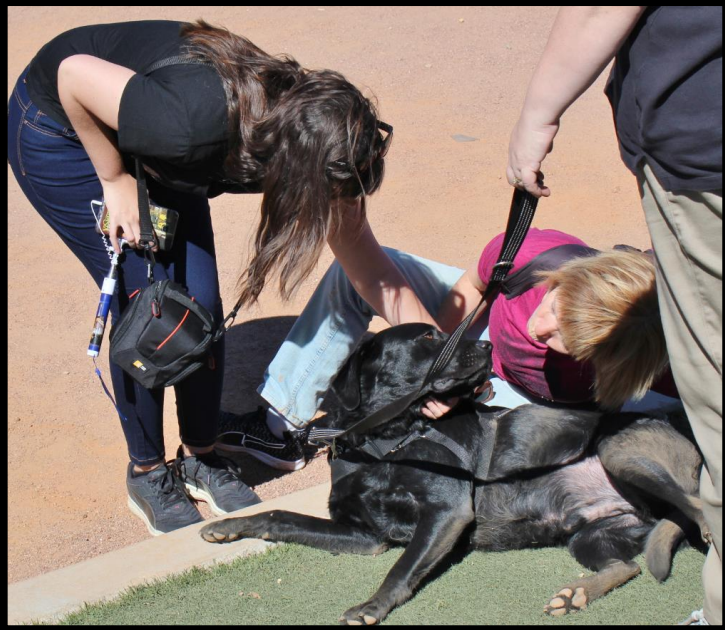



First Baptist Church



November 5, 2017
26 Killed
20 Injured



*First Baptist Church
of Sutherland Springs*

JOIN US
FALL FEST
OCT 31 6 TO 8 PM



WELCOME

PASTOR FRANK POMEROY

SUNDAY

9:15 AM BREAKFAST FELLOWSHIP

9:45 AM SUNDAY SCHOOL

11:00 AM MORNING WORSHIP

2nd Fri. EVENING SPANISH MISSION 7:00

6:00 PM EVENING SERVICE







HOLCOMBE FAMILY















MEMORIAL SERVICE

BAPTIST CHURCH

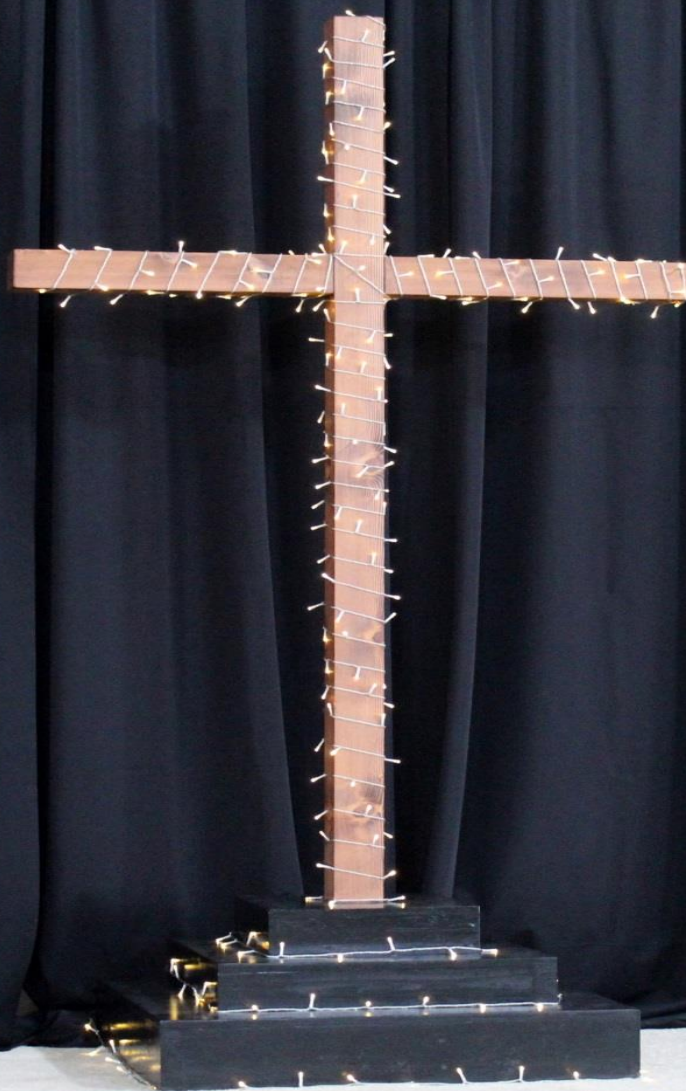















**First Baptist Church
Pre-November 5th**



Bob

Shari

Marc

Noah



***Marjory Stoneman Douglas
High School***

Inside the Parkland school shooting



Building 12



Marjory Stoneman Douglas High School

3rd floor

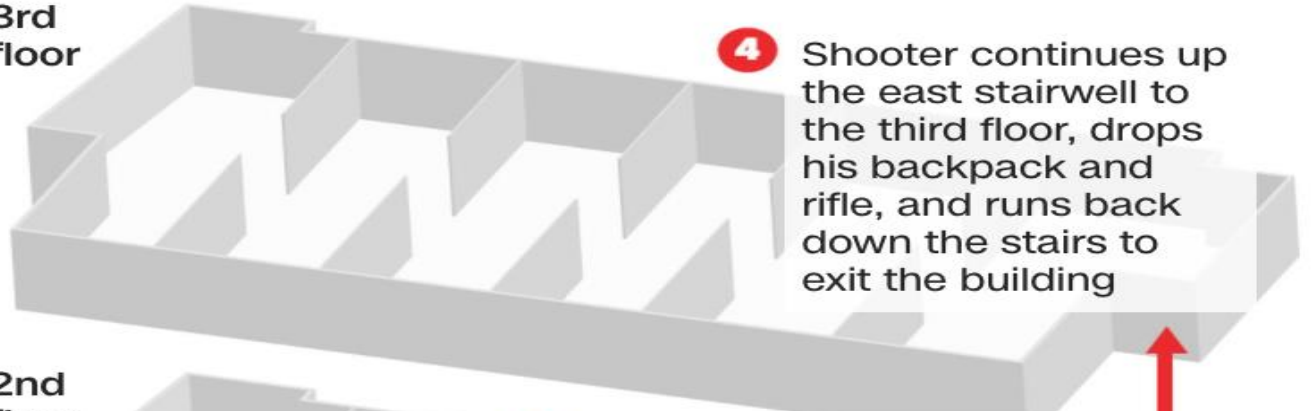

4 Shooter continues up the east stairwell to the third floor, drops his backpack and rifle, and runs back down the stairs to exit the building

2nd floor

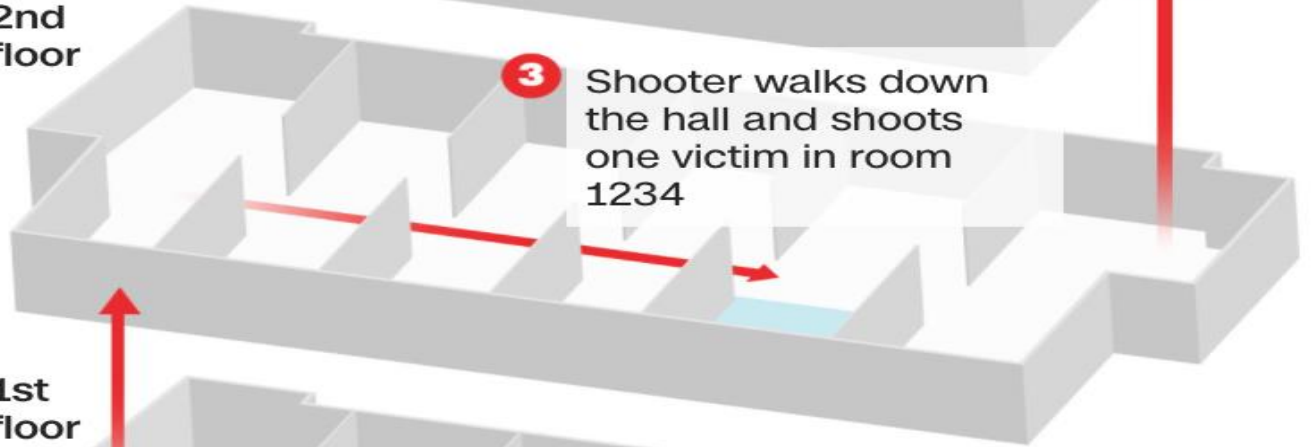

3 Shooter walks down the hall and shoots one victim in room 1234

1st floor

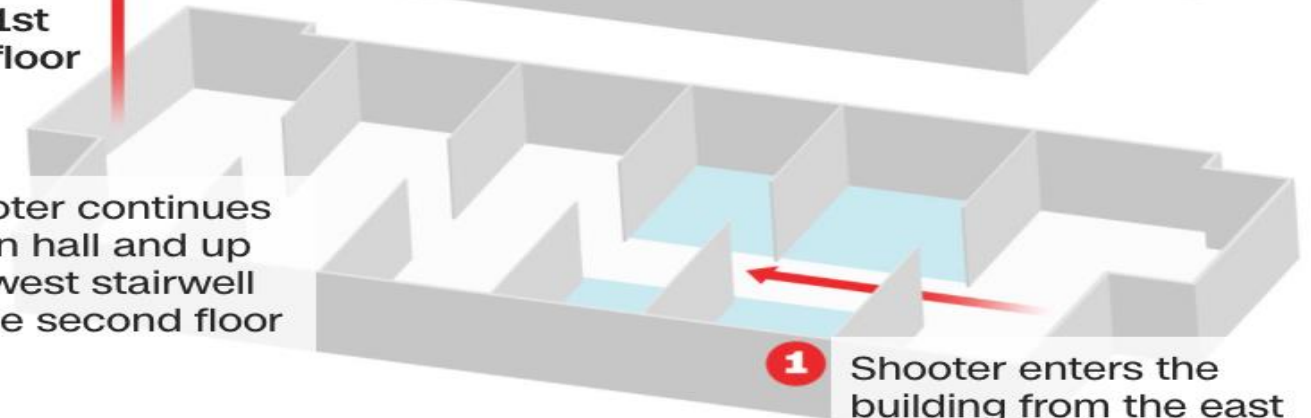

2 Shooter continues down hall and up the west stairwell to the second floor

1 Shooter enters the building from the east stairwell and fires into four classrooms



February 14, 2018



Marjory Stoneman Douglas High School
Parkland, FL
Mrs. Scott Beigel



Marjory Stoneman Douglas High School Heroes



Colton Haab



Anthony Borges



Peter Wang, 15



Ashley Kurth



Coach
Aaron Feis, 37

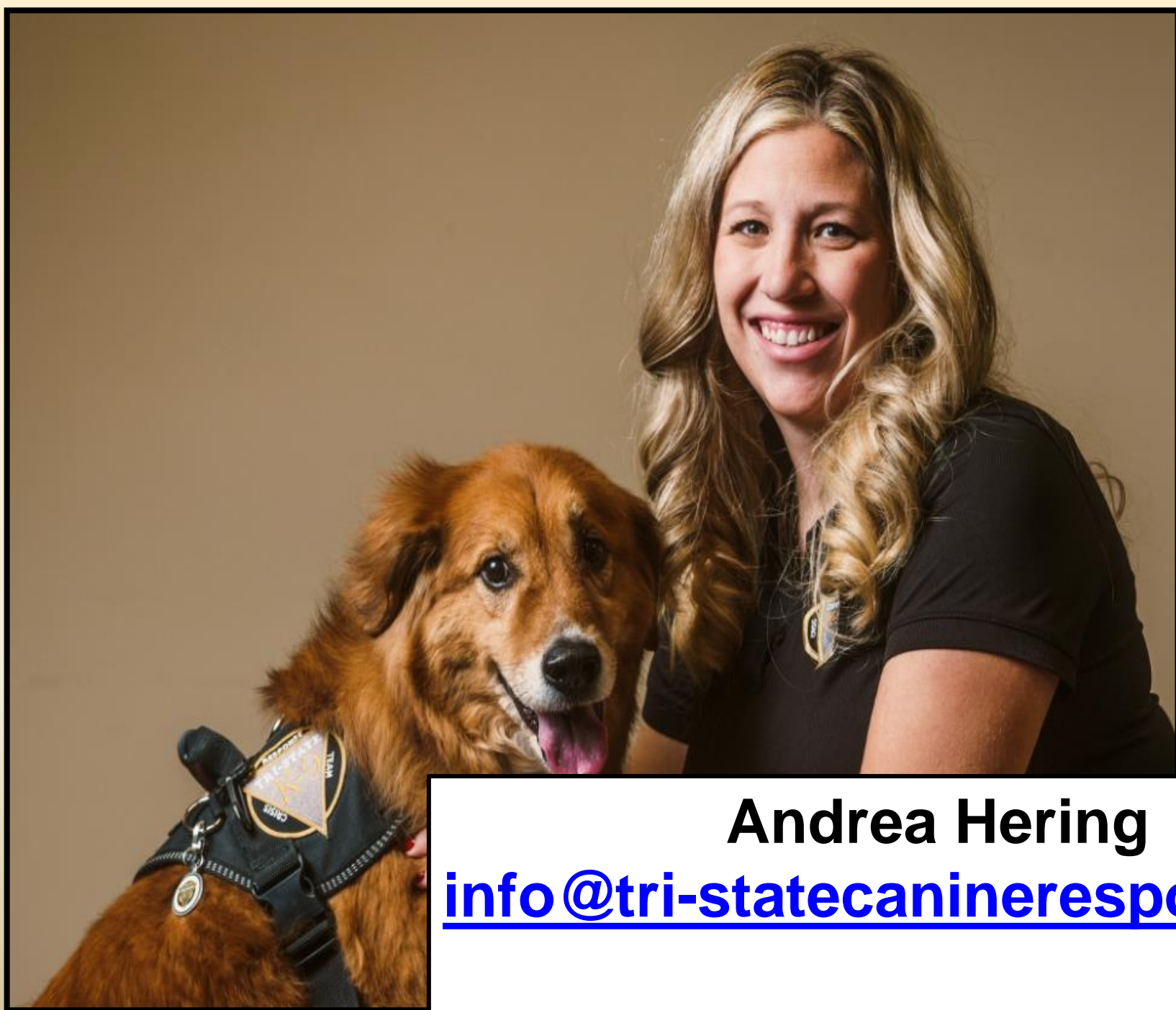

Andrea Hering
info@tri-statecanineresponse.org



Tri-State Canine Response Team

Providing emotional support with registered teams of dogs and handlers